

Brunswick College Parkette Design Competition

The existing Parkette follows two main directions: to the Health Centre ground floor and to Saint Stephens' Church. This project holds the existing directions, but has a different shape in section. I designed three big "steps", with its own function: walking for the highest one, next to the street side; then, a step to stay, with chess tables; the last one is closed to the Health Centre and it would accommodate the Health Centre Outdoor Café. The big steps are connected by stairs and ramps.

There are some little green areas, which correspond to seats on the lower step; they are also provided by steel and wooden backs.

In addition to streetlights, some lights have been placed next to the ground.

There is a spire bike rack, too,... so people could park their bikes next to the telephones no more!

“Americans are not **plaza people** [...] only when plaza did not relate to any activity, with no functional reason for their being. What we do need are small-scaled plazas **outdoor living rooms**”

Lawrence Halprin

- 1_bike parking
- 2_fountain
- 3_chess tables
- 4_Kensington Health Centre Outdoor Café
- 5_telephones

BRUNSWICK AVENUE



KENSINGTON HEALTH CENTER 340 COLLEGE STREET

siteplan_scaled 1/100 (metres)

Brunswick-College Parkette

Design Competition

COLLEGE STREET

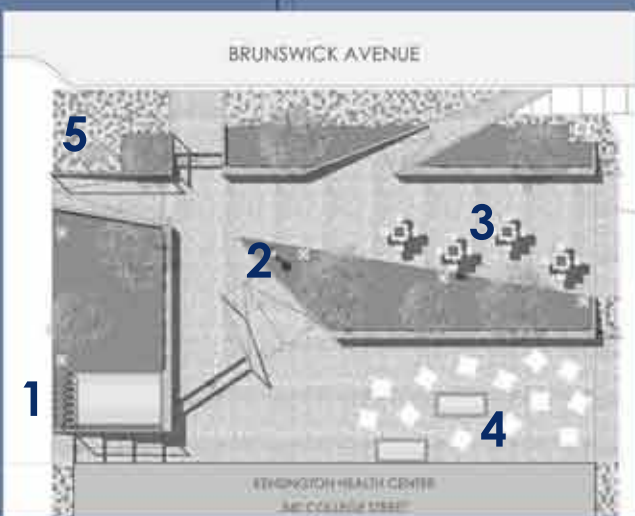

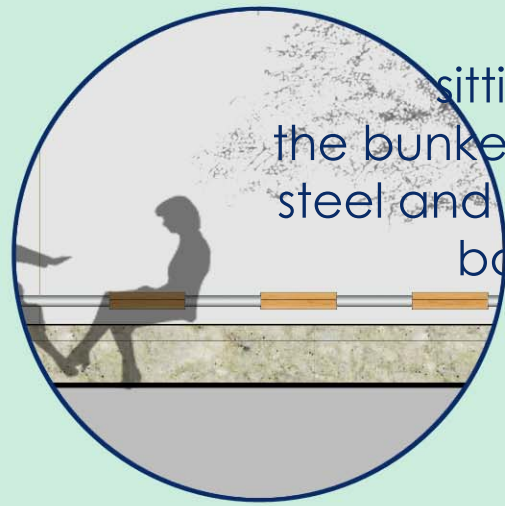
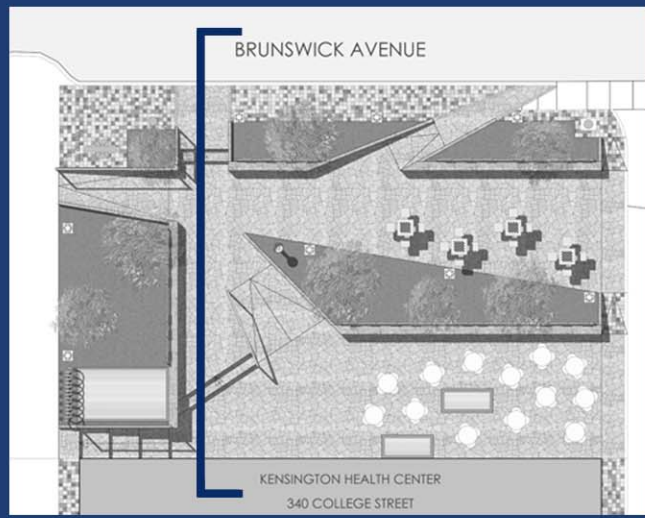

detail
sitting on
the bunker wall,
steel and wood
backed



detail
bike parking

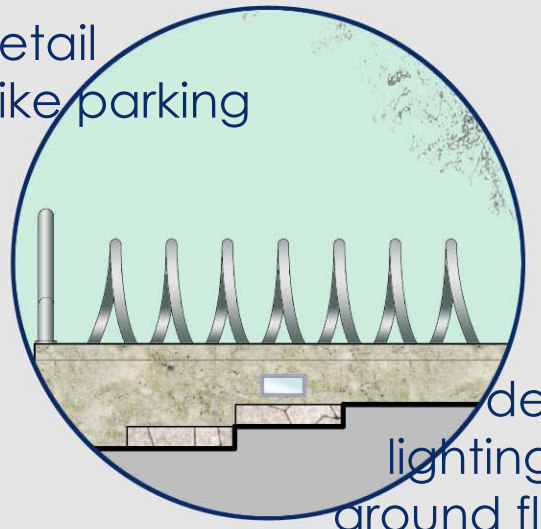

detail
lighting at
ground floor



**Brunswick-College Parkette
Design Competition**