

KENSINGTON SQUARE
Florian Müller
Berlin, Germany

Brunswick-College Parkette Design Competition

Sponsored by the Harbord Village Residence Association
in association with the City of Toronto



Site Plan

College Street / Brunswick Avenue
Scale 1:250



Perspective 01

Brunswick-College Parkette /
Kingston Health Center

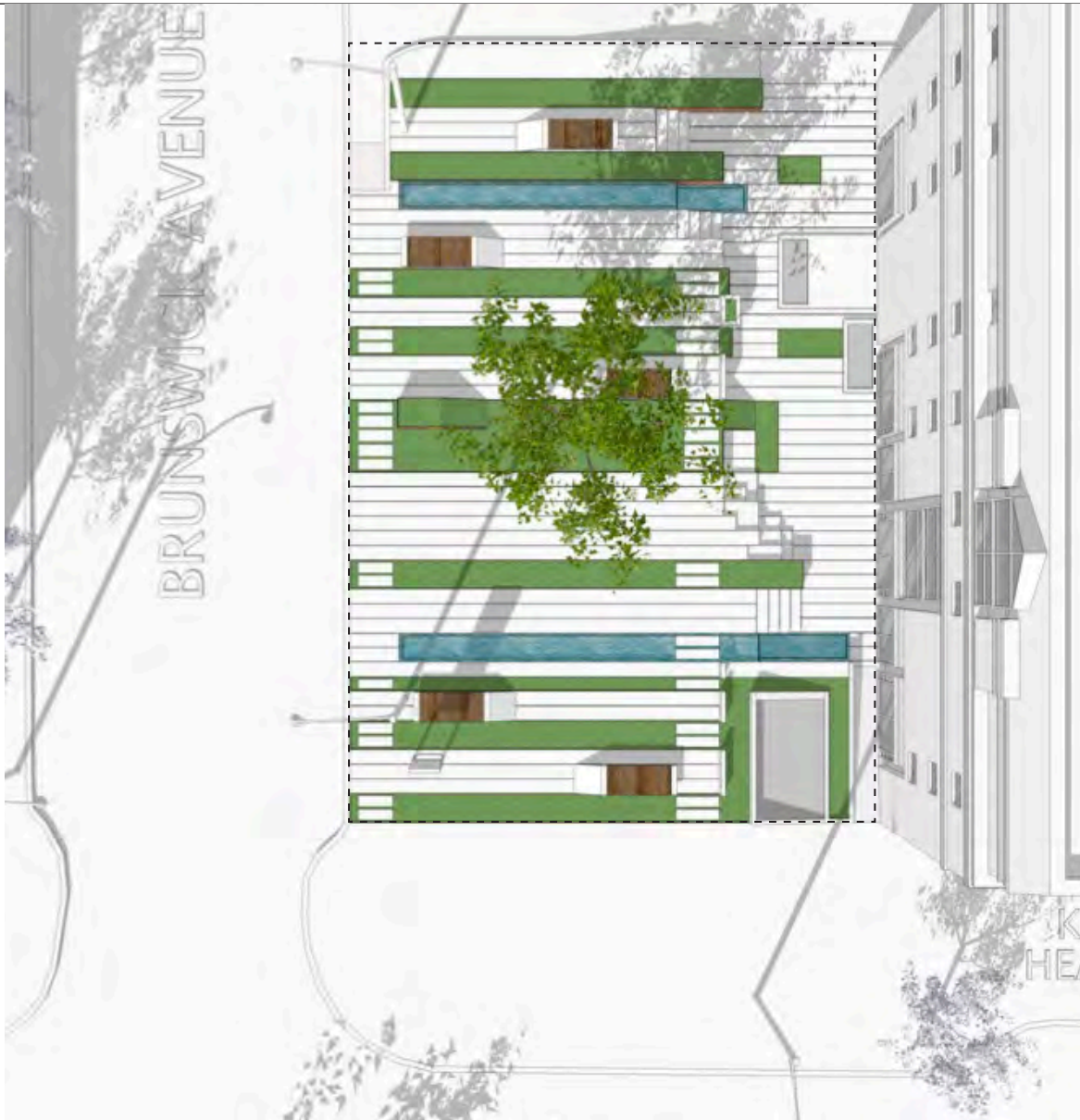

The competition area is not an urban space at the moment. The scrubs and trees planted in the 80's transformed into a jungle. The strong separation between Kensington Health Center and the Brunswick-College Parkette by a massive concrete planter box intensified the not carming charactor of this place in the cultural heart of the city.

So the architectural concept has to be:

STABILITY - UTILITY - AMENITY

To gain this concept, the existing structure has to be deconstructed in most parts.

Three major elements will dominate the square in the future: limestone, grass and water. All elements are natural elements. Rusted steel fins will be used to separate the elements and to create a difference in the water level.

To connect the Kensington Health Center better to the Parkette, multiple stairs and ramps will be added in generous dimensions and styles.

Another major design issue is to remove the "garbage-trapping iron benches" and replace them by free standing design benches with wooden decking on the square. Residents as well as tourist will enjoy a break here. Another advantage of the free standing design is the impossibility to use the benches any longer for sleeping.

But not just the benches will host comfort. By removing the concrete planter box future cafés, shops or social institutions have the possibility to use outside seating areas, while not interfering with the public use of the square.

The greenery concept itself is simple and easy to maintain in the future. Instead of planting a lot of trees and scrubs again, one striking maple will dominate the square. The grass inside its boxes can be cut easily.

The expressive and efficient design allows the promotion of the parkette with its prime location to the neighbourhood and the city.



Perspective 02

Brunswick-College Parkette /
Kingston Health Center



Layout Plan



Elevation

Brunswick-College Parkette /
Kingston Health Center



Perspective 03

Brunswick-College Parkette /
Kingston Health Center